

Assignment for Week 4/6-4/10

Agenda:

- **Read Welcome letter (outlines how distant learning will work)**
- ***Analyzing Art (30 points- post to [turnitin.com](https://www.turnitin.com))**
- ***Bell work Prompts (10 points total- take pictures and post to [turnitin.com](https://www.turnitin.com))**
- ***Complete Outline for your project (10 points- take a picture and post to [turnitin.com](https://www.turnitin.com))**

* Things with a star will require you to submit something for points

Welcome Back Students!

This is a new experience for us all. I know the situation is uncertain and I'm sure many of you are quite anxious and stressed. We're going to figure it out together.

I would highly recommend, all students join our class RemindApp group. I will send out reminders of assignments, due dates, and office hours. You can also contact me with questions that way as well. All class codes are located on my teacher page on the HHS website.

I will have daily email "office hours" where I will quickly respond to emailed questions or concerns about projects, assignments or grades. This will be daily M-F from 8am-9:30am. You may email me with questions outside of those hours, however it may take me a bit longer to reply to inquiry. When you email me please put your First and Last Name, along with your period number somewhere in the email! If you don't put your name I have no way of knowing who it is.

I will also be holding weekly optional zoom meetings. Zoom is a video conferencing platform for us to communicate. You may log on and video chat to get help on assignments, ask questions, or just hang out with me and say hello (I get bored during quarantine too). Each week, I will have the meeting day, time, and link posted to the welcome page. If you are using your phone, you must have the zoom app downloaded for the link to work. When you log in, please put your first and last name as your username, so I know who you are and can let you into the chat. You Do Not need to make an account! If the day and time posted does not work for you, but you need face to face help, please email me and we will find a time that works for us both.

You will have assignments given to you weekly.

Those of you who have access to technology:

- Assignments will be posted on my Teacher Welcome Page as well as the Beginning Art Assignments Page, every Monday by 9am.
- All work will be due by Sunday at Midnight. You will be submitting all work to [turnitin.com](https://www.turnitin.com)
- I have the class code posted on the Welcome Page of my teacher website. If you have any trouble submitting work on there, please email me! I want to ensure you get

DUE BY SUNDAY APRIL 12 AT MIDNIGHT

points for the work you complete and do not get docked points for submitting assignments late.

- If you do not submit work by midnight on Sunday, it will be considered late.
- Regular late work policy will be in effect.

For those of you who do not have access to technology:

- You will need to pick up your work packets from the main office on campus, Mondays starting at noon.
- You will drop off the previous week packet on Monday when you pick up your new one.
- If the work is not submitted on Monday it will be considered late.
- Regular late work policy will be in effect.

Assignments will usually include an analyzing art assignment, a few bell works or smaller assignments, and parts of a comprehensive project to complete.

The analyzing art assignment should take you no more than 20 minutes to complete and no less than 10 minutes. We have done this in class as groups rather than individually. When analyzing art, don't forget to ask why. Why is the artist making this piece, why are they using specific colors, why are they using perspective. And how. How does their technique influence the way the piece is viewed? For those of you who are already planning on Googling what the piece is about, I'm one step ahead of you. When you submit your work to turnitin.com, it checks your work for plagiarism. It will tell me if you copied and pasted from a website, or if you and a friend have the same thing written on your assignment. Plagiarism policy is in effect. If you are caught cheating, you get a zero. If you and your friend copied off each other, you both get a zero. No exceptions, no make ups.

Please reach out if you have any questions, comments, concerns, amendments, objections, suggestions, or just want to say hello.

Stay safe!

Ms. Nakamura

DUE BY SUNDAY APRIL12 AT MIDNIGHT

Analysing Art

Content – looking at the subject of the work

What is it? What exactly can you see? What is happening? What does the work represent?

What does the artist call the work?

Does the title change the way we see the work?

What is the theme of the work?

landscape, portrait, journey, moment, memory, event, surreal, fantasy, abstract, message, energy

Form – looking at the formal elements

What colours does the artist use? Why? How is the colour organised?

What kind of shapes can you find?

What kind of lines and marks does the artist use?

What is the surface like?

What kind of textures can you see?

What kind of patterns can you see?

How big is the work?

light, delicate, layered, strong, rough, dark, peaceful, dripped, textured, scale, vivid, bright

Process – how the work has been developed and made

What materials and tools have been used?

What is the evidence and clues for how it has been made?

Painted, woven, printed, drawn, cast, stitched, layered, assimilated, collage

Mood – looking at the communication of moods and feelings

How does the work make you feel?

Why do you feel like this?

Does the colour, texture, form or theme of the work affect your mood?

quiet, contemplative, thoughtful, hopeful, peaceful, elated, joyful, celebratory, reflective

Interpretation and Justification – looking at the meaning of the work

After analysing the context, form, process and mood:

What do you think the artist is saying? Why?

What message is the work/artist trying to communicate? Why?

DUE BY SUNDAY APRIL 12 AT MIDNIGHT

Analyzing Art

*This is the only page you need to turn in for the Analyzing Art Assignment

Name: _____ Per: _____

Date: _____

Content:

Form:

Process:

Mood:

Interpretation/Justification:

Week of April 6-10th



Title: *Le Pont de l'Europe* (English title: *The Europe Bridge*)

Artist: French impressionist painter Gustave Caillebotte

Medium: Oil Painting

Size: 49 in × 71 in

Date completed: 1876

Bellwork

You all know how to do Bellwork. We do it EVERY DAY! If it does not look like you spent at LEAST 10 minutes on each drawing, I will mark you off points. They are 5 points each prompt. Draw your Bellworks on a piece of printer paper, write the prompt at the top of the page, take a picture of your work, and submit to [turnitin.com](https://www.turnitin.com).

If you need help filling your 10 minutes, make sure your perspective is correct, add details, add shading, add a background, or draw multiple things.

Prompt #1:

Something you did over Spring Break

Prompt #2:

Draw the perfect Deli Sandwich

Make a list next to your drawing of everything that is in it
(NO PB&J's, and NO HOTDOGS...they are not sandwiches)

Directions for the 1pt. Perspective Room Drawing

For this room project you will be drawing a room in perspective. Everything you draw in the room must be done in perspective. You must color your drawing using both colored pencils and markers.

Step 1.

Draw Horizon Line and place vanishing point in the center.

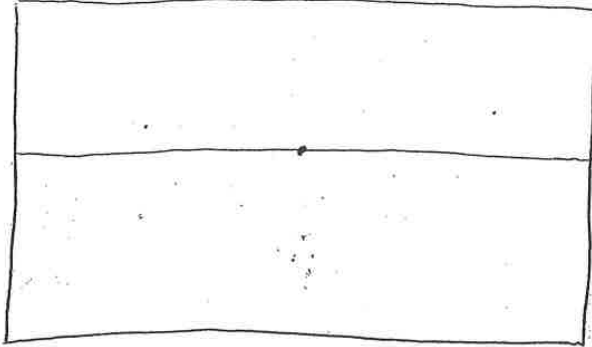

Step 2:

Draw lines from corners of paper to vanishing point.

Step 3:

Draw a rectangle using the corner lines for your corners.

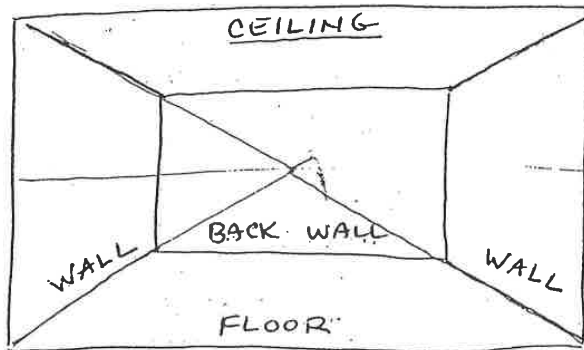

Step 4:

Erase horizon line (but not VANISHING point!) and all lines on back wall.

Step 5: (ALL MUST BE DRAWN IN PERSPECTIVE)

Furnish your room with the following (this is the minimum – adding more furnishings will help your drawing):

4 pieces of furniture

1 window

1 door

A rug

A lamp

A picture (poster) on wall

4- details (lamp, phone, alarm clock, shoes, clothing, etc.)

*Include all details to make the room as realistic as possible (plants, folds in material, textures, etc.)

Couch or chair

Start with shape 

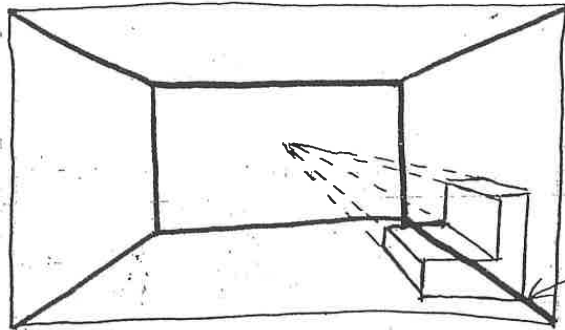

* DO NOT GO PAST CORNER WHERE WALL MEETS FLOOR!

-Make guidelines from corners to vanishing point

-Finishing far end with lines parallel to front  shape

-Add – Rounded edges; folds in material; cushions; arms; pillows; etc. for realism.

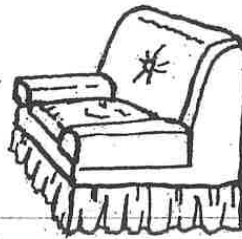
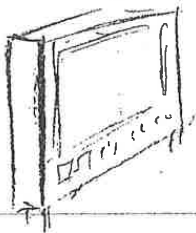

BED:

-Start with



-Make guidelines from
Corners to vanishing point.

-Finish back edge parallel to front

-Add bedding: blankets, pillows, Bedsread, etc. (Hint; Round corners and soften line edges.)

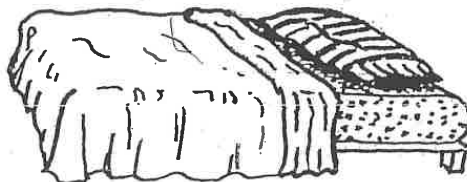

DUE BY SUNDAY APRIL 12 AT MIDNIGHT

Grading Rubric for One point perspective drawing assignment (80 pts. Total for project) Total: _____/80

1 – Room has a minimum of four pieces of furniture. (Chair, tables, bed, bookshelf, couch, etc.) (5pts each)
_____ /20

2 – Sense of perspective is drawn accurately (lines are vertical, or aim for the vanishing points correctly).
_____ /10

3 – Composition includes a variety of stylistic details beyond “bare minimum. Room includes details listed in the handout to create a realistic believable room such as:

- Pictures on the wall, rugs, posters, lamps, windows, etc.
- Plants, light switches, molding, patterns, textures on surfaces and furniture
_____ /30

4 – Design is complex and challenging, appropriate for high school skill level. Coloring shows controlled (smooth) shading. Drawing looks complete (no white background showing) and neatly done (no “erased” pencil lines showing) carefully handled, edges and corners are intact, not wrinkled, torn, stained, folded, etc. (5pts)
_____ / 20

Total points = 80

72-80 = A

64-71 = B

56-63 = C

48-55 = D

Below 47 = F

Project

When we got back from break, I was planning on having us learn printmaking and scratch board, however, since y'all don't have proper materials at home, we are unable to do these projects :(

We are going to revisit perspective briefly while we get our bearings of the "distant learning" shenanigans. I know a lot of you are probably groaning at this right now, BUT it should be easy because you have already done perspective and are experts at it now!

Your assignment will be to draw your dream bedroom. For those of you who like to game, you can set up your room to be completely tricked out with gaming consoles and monitors. For those of you who love sugar, you can turn your room into a Willy Wonka Candy land. Anything you can imagine, is okay with me (school appropriate of course). **I will attach the rubric and directions on the bottom of this document, as well as on the class webpage, LOOK AT IT. It is there to help you so you know what you are getting graded on.**

I know you don't have the same materials as class so for this assignment, you will need:

- A regular piece of printer paper (if you have larger and would like to use it, you may)
- A pencil
- A Sharpie or black pen (for outlining)
- Colored Pencils or markers (You will need these in a few weeks)

THIS WEEK!

You must draw/sketch your Dream Bedroom with pencil in **CORRECT PERSPECTIVE!**

When you are done drawing it with pencil, take a picture of your progress and upload it to [turnitin.com](https://www.turnitin.com)

This progress picture is for a grade!!!

I will post a few youtube videos on the class web page as references to help you get started with your rooms

We will add to this drawing in the following weeks with detail and color so **DO NOT THROW IT AWAY!** You still need it!

Let me know if you have questions, comments, concerns, amendments, suggestions, objections :)

Good Luck!

Ms. N